

PRODUCT FOCUS

WINDOWS, GLAZINGS AND FILMS

Film Offers Energy Savings, ROI
SAN DIEGO — Solar Gard window film helps stabilize interior temperatures and offers savings up to 30 percent, the company reports. In addition to the energy saving benefits, Solar Gard window film can eliminate heat pockets



throughout a building, reduce glare and reject 99 percent of UV radiation. Solar Gard also provides full-service energy analysis offering an anticipated return on investment using building information modeling. www.solargard.com.
Bekaert Specialty Films, LLC | Reader Service No. 203

Panels Contain 100 Percent Recyclable Material
CORAL SPRINGS, FLA. — Vistamatic, a designer and manufacturer of observation window



systems, announced that all Vistamatic vision panel systems consist of 100-percent recyclable material, including glass and galvanized steel components. Vistamatic vision panel observation windows are designed for a multitude of environments, including healthcare, institutional, event and corporate centers. www.vistamaticvisionpanels.com.

Vistamatic | Reader Service No. 204

Clear Window Film Offers Guarantee, Warranty

HOUSTON — V-Kool window films provide energy savings for a variety of applications, including commercial, residential and automotive. According to the company, V-Kool window film lets in more than 70 percent of the sun's natural light while blocking heat. V-Kool



film is installed by highly trained professional installers and all residential/commercial window film is fully guaranteed and has a full warranty. www.v-kool-usa.com.

V-Kool Inc. | Reader Service No. 205

Energy-Saving Windows and Doors

SUNNYVALE, CALIF. — Serious Materials' ThermaProof energy-saving windows are designed for both commercial and residential construction and offer R-values of R-5 to R-11, the company reports. ThermaProof windows combine an enhanced Alpen-Glass+ insulated glass package with fully insulated framing systems to achieve the highest insulation performance across the full-frame and not just at the center of the glass. www.thermaproof.com.

Serious Materials | Reader Service No. 206

BUILDING CONTROLS AND AUTOMATED SYSTEMS

Easy-to-Install Wireless Occupancy Sensor

COOPERSBURG, PA. — The Wireless Occupancy Sensor from Lutron Electronics Co., Inc. is specifically designed for easy installation in conference rooms, copy rooms, small offices, classrooms, living rooms, bedrooms, restrooms

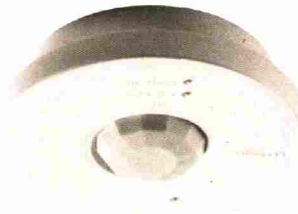

and other spaces where automatic lighting shut-off is desirable. The sensor is placed on the ceiling and coupled with a compatible Lutron dimmer or switch. According to the company, no wiring is required to the sensor. www.lutron.com/occsensors.

Lutron Electronics Co., Inc. | Reader Service No. 207

Simple-to-Use Daylighting Control

ROSEMONT, ILL. — Philips Lighting Electronics North America's LuxSense Lighting Control is an easy-to-use means of automatically achieving a comfortable level of illumination, the company reports. Designed to control up

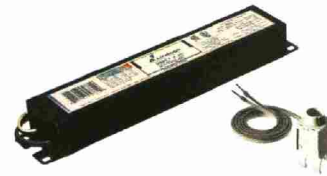

to 20 fixtures, the LuxSense daylight sensor possesses the ability to be incorporated directly into a fixture or alternatively clipped to a high-efficiency T5 lamp using a clip included in the package. www.philips.com/advance.

Philips Lighting Electronics North America | Reader Service No. 208

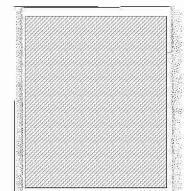

**Remotely Manage Retail
Operation Systems**

AUSTIN, TEXAS — Site Controls' Web-enabled Site-Command clean energy management solution (EMS) allows retailers to centrally monitor and manage a site's lighting, air conditioning, signage and other equipment across hundreds or thousands of locations, the company reports. With Site-Command, retailers can lower monthly energy costs and ongoing maintenance expenses and reduce their carbon footprint without sacrificing customer comfort. www.site-controls.com.

Site Controls | Reader Service No. 209

**Control Tool for Small
Commercial Businesses**

LARKSPUR, CALIF. — EcoView Commercial, from Advanced Telemetry, LLC, is a next-generation climate control and resource management solution for commercial applications, the company reports. Users can view, in real-time, temperature set-points and settings, schedules, electricity and water consumption, follow trends, track changes, identify key culprits of energy drain, set consumption goals, and directly control how resources are being used. Remote monitoring is available and can be used to manage multiple locations. www.advancedtelemetry.com.

Advanced Telemetry, LLC | Reader Service No. 210



Sunlight Control

AUSTELL, GA. — YKK AP's C2C-certified ThermaShade system is designed to improve tenant comfort and lower energy consumption by decreasing solar heat



gain. This system offers a wide spectrum of design options and is available in both anodized and all YKK AP standard or premium paint colors, the company reports. Options and features include a patent-pending thermally broken anchor to secure the ThermaShade to the curtain wall, four standard outrigger design options, eight standard louver options and five standard fascia options. www.ykk-ap.com.

YKK AP | Reader Service No. 212

**Carpet Collection Designed for
Heavy Traffic**

DALTON, GA. — Captivate and Intrigue are two new tile products and are a part of Shaw Contract Group's No Rules collection. According to the company, both offer performance ideal for high traffic installations in the



education, healthcare and workplace markets. Colors range from bright, saturated colors to sophisticated neutrals. No Rules is Cradle to Cradle Certified and utilizes EcoWorx tile backing. www.shawfloors.com.

Shaw Contract Group | Reader Service No. 211

**Insulated Composite
Backup Solution**

MOON TOWNSHIP, PA. — CENTRIA's Metal-Wrap is a backup system alternative designed specifically for CENTRIA Profile Series and FormaBond metal wall systems. This foam-insulated composite backup system's 2-inch thick panels provide an R-value of 14, while 3-inch thick panels test at R-21. The panel's unique clip design minimizes penetration of the air barrier. Additionally, the clip system allows for either

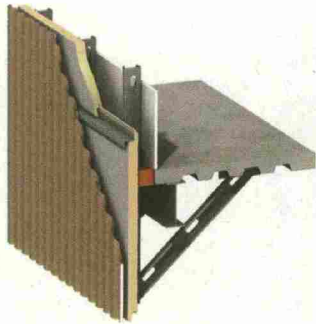

vertical or horizontal installation of the exterior cladding. <http://metalwrap.centria.com>.
CENTRIA | Reader Service No. 213

STRUCTURAL SHEATHING AND FRAMING

Fiberglass-Faced Gypsum Liner Panels

AUSTIN, TEXAS — GreenGlass Liner Panels from Temple-Inland are designed to deliver the mold and moisture resistance of fiberglass facers with 90-percent recycled content. The company reports, GreenGlass liner panels are



U.L. approved for use in multiple two-hour shaft and area separation wall assemblies and are available in a 2-foot width, 1-inch thickness and lengths of 8 feet, 10 feet and 12 feet. www.greenglassinfo.com.

Temple-Inland | Reader Service No. 214

Cost-Effective Entry Into Green Market

MIDLAND, MICH. — Dow Building Solutions' STYROFOAM SIS can help improve a home's thermal performance by R-5.5 (at 1.0-inch) or



R-3.0 (at 0.5-inch), the company reports. STYROFOAM SIS allows homes to be built without having to add insulated sheathing. STYROFOAM SIS is up to 80-percent post-consumer recycled content by weight, one-third the weight of OSB, and meets code for a water-resistant barrier. www.dowsis.com.

Dow Building Solutions | Reader Service No. 215

Glass-Mat Sheathing Panels

CHICAGO — SECUROCK glass-mat sheathing panels from USG have a non-combustible, moisture- and mold-resistant gypsum core that achieves an ATSM 10 rating for mold resistance. The panels are encased in a double-sided,



green-colored fiberglass facer and are easy to score and snap with no saws or special tools required, the company reports. SECUROCK glass-mat sheathing is ideally suited for use under exterior claddings where conventional gypsum sheathing products have traditionally been used. www.usg.com. 

USG Corporation | Reader Service No. 216